



# Malleable Iron Pipe Fittings

## CRANE

### Male x Female Reducing Elbow (Fig 152)



Black, BSPT

1091			£
C152-34-12N	3/4"	1/2"	11.55
C152-1-34N	1"	3/4"	15.95

Galvanised, BSPT

1091			£
C152-34-12	3/4"	1/2"	17.60
C152-1-12	1"	1/2"	17.75
C152-1-34	1"	3/4"	24.25

### Female Equal Elbow (Fig 151)

Tech Sheet 10675



Black, BSPT

1091		£
C151-18N	1/8"	3.25
C151-14N	1/4"	2.30
C151-38N	3/8"	2.30
C151-12N	1/2"	2.05
C151-34N	3/4"	2.80
C151-1N	1"	4.30
C151-114N	1.1/4"	7.55
C151-112N	1.1/2"	12.75
C151-2N	2"	14.95
C151-212N	2.1/2"	32.30
C151-3N	3"	47.40
C151-4N	4"	116.30

Galvanised, BSPT

1091		£
C151-18	1/8"	6.25
C151-14	1/4"	4.10
C151-38	3/8"	4.10
C151-12	1/2"	3.55
C151-34	3/4"	4.90
C151-1	1"	7.65
C151-114	1.1/4"	15.90
C151-112	1.1/2"	23.80
C151-2	2"	27.90
C151-212	2.1/2"	62.20
C151-3	3"	91.35
C151-4	4"	156.90

### Twin Elbow (Fig 197)



Black, BSPT

1091		£
C197-12N	1/2"	11.70
C197-34N	3/4"	12.45
C197-1N	1"	20.10
C197-112N	1.1/2"	52.35
C197-2N	2"	73.70

Galvanised, BSPT

1091		£
C197-12	1/2"	24.50
C197-34	3/4"	27.10
C197-1	1"	43.90
C197-114	1.1/4"	88.00
C197-112	1.1/2"	111.40
C197-2	2"	143.20

### Female Reducing Elbow (Fig 151)

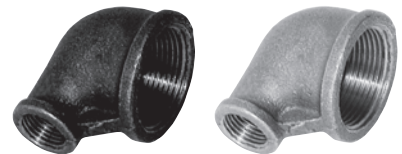

Black, BSPT

1091			£
C151-38-14N	3/8"	1/4"	4.40
C151-12-14N	1/2"	1/4"	5.80
C151-112-1N	1.1/2"	1"	14.45
C151-2-1N	2"	1"	25.40
C151-2-112N	2"	1.1/2"	25.80

Galvanised, BSPT

1091			£
C151-12-14	1/2"	1/4"	11.10
C151-34-12	3/4"	1/2"	7.10
C151-1-12	1"	1/2"	8.85
C151-1-34	1"	3/4"	10.50
C151-114-12	1.1/4"	1/2"	17.40
C151-114-34	1.1/4"	3/4"	23.80
C151-114-1	1.1/4"	1"	17.40
C151-112-1	1.1/2"	1"	27.00
C151-2-1	2"	1"	47.60

Hydraulics

Hydraulic QRC

Pneumatic QRC

Ind. Air Prep., Monitor & Test

KELM™ Pneumatics

Pneumatic & Vacuum Equipment

Valves

Ring Main Systems

Adaptors & Fittings

Stainless Steel

Malleable Iron

Hose, Tubing & Couplings

Clamps & Clips

Sprays & Adhesives

Blow Guns & Vacuum

Wash Down & Fuelling

Air Tools

Tools, Hardware & PPE

For **PNEUMATIC POWER TOOLS** see pages 1426-1431

**AEROPRO**

