



## Clamp Components



### Series A Fixing Bolts

Tech Sheet 813



Slotted Head, Steel

0162	Group	£
SL-A0/A1	0 & 1	0.15
SL-A2	2	0.15
SL-A3	3	0.15
SL-A4	4	0.25
SL-A5	5	0.30
SL-A6	6	0.35

Tech Sheet 813



Socket Head, Steel

0162	Group	£
IS-A0/A1	0 & 1	0.35
IS-A2	2	0.35
IS-A3	3	0.35
IS-A4	4	0.35
IS-A5	5	0.50
IS-A6	6	0.65

Tech Sheet 1391



Stacking Head, Steel

0162	Group	£
AS-A0/A1	0 & 1	1.10
AS-A2	2	1.30
AS-A3	3	1.50
AS-A4	4	1.65
AS-A5	5	2.05
AS-A6	6	3.05

Stacking Head, Stainless Steel

0162	Group	£
AS-A0/A1-SS	0 & 1	6.75
AS-A2-SS	2	6.95
AS-A3-SS	3	6.95
AS-A4-SS	4	6.95
AS-A5-SS	5	7.00
AS-A6-SS	6	7.35

Tech Sheet 813

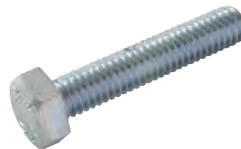

Hexagon Head, Steel

0162	Group	£
SSL-A0/A1	0 & 1	0.35
SSL-A2	2	0.30
SSL-A3	3	0.30
SSL-A4	4	0.35
SSL-A5	5	0.50
SSL-A6	6	0.65
SSL-A7	7	1.00

Hexagon Head, Stainless Steel

0162	Group	£
SSL-A0/A1-SS	0 & 1	1.00
SSL-A2-SS	2	1.10
SSL-A3-SS	3	1.25
SSL-A4-SS	4	1.45
SSL-A5-SS	5	1.90
SSL-A6-SS	6	2.20

### Visitec Clamping Nuts, Light Series

The rail nut with loss protection. The larger flange area prevents the rail nut falling into the rail during installation which is a problem inherent to the traditional design. The new design has a vibration & sound installation function. The rubbercap has an intergrated screw locking device. Fast & easy to install, easy to adjust, especially for vertical installations.

#### Advantages:

- Vibration & sound insulating function
- Designed especially for vertical installations
- Fast & easy to install
- 40% time savings for installers

Tech Sheet 1981



Series A, Chromium VI-Free

0162	Group	Series	£
TM-A/B1VISITEC	All A & B1	A & B1	1.10

Series A, Stainless Steel

0162	Group	Series	£
TM-A/B1SSVISITEC	All A & B1	A & B1	9.95

### Clamping Nuts

Tech Sheet 1640



Series A, B & C, Chromium VI-Free

0162	Group	Series	£
TM-A	All A & B1	A & B1	1.25
TM-B2	2-5	B	2.90
TM-C1	1-3	C	4.60
TM-C4	4	C	7.90

Series A, B & C, Stainless Steel



0162	Group	Series	£
TM-A/B1	All A & B1	A & B1	11.85
TM-B2-SS	2-5	B	10.10
TM-C1-SS	1-3	B	24.15
TM-C4-SS	4	C	26.55

### Clamping Rails

Tech Sheet 1640

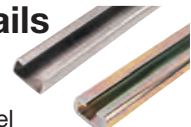

Series A, B & C, Steel

0162	Series	L mtrs	Depth mm	£
TS11-A/B1	A & B	1	11	9.70
TS11-A/B2	A & B	2	11	19.30
TS14-A/B1	A & B	1	14	9.90
TS14-A/B2	A & B	2	14	19.70
TS-C1	C	1	22	36.85
TS-C2	C	2	22	73.85

Series A, B & C, Stainless Steel

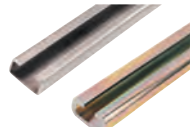

0162	Series	L mtrs	Depth mm	£
TS11-A/B1-SS	A & B	1	11	45.50
TS11-A/B2-SS	A & B	2	11	91.05
TS14-A/B1-SS	A & B	1	14	51.00
TS14-A/B2-SS	A & B	2	14	101.95
TS-C1-SS	C	1	22	183.70
TS-C2-SS	C	2	22	367.40

### Locking Washers

Tech Sheet 1391



Series A & B

0162	Group	£
US-A	1	0.60
US-B2	2-5	0.70