



## Hydraulic Adaptors

### 1/8" - 1" 210 bar    1.1/4" - 2" 130 bar

Section 1 - Hydraulics

### Plugs



SAE O-Ring Boss  
Male Solid Plug c/w O-Ring

0014		£
19162	5/16"	3.75
19150	7/16"	3.05
19151	1/2"	3.40
19152	9/16"	3.75
19153	3/4"	4.15
19154	7/8"	4.85
19155	1.1/16"	7.10
19156	1.3/16"	8.70
19157	1.5/16"	12.15
19158	1.5/8"	21.60
19159	1.7/8"	29.30
19160	2.1/2"	43.10

### Crosses



BSPP Male Cross  
60° Cone for Bonded Seal

0014		£
03007	1/8"	19.25
03000	1/4"	19.25
03001	3/8"	23.10
03002	1/2"	27.80
03003	5/8"	39.15
03004	3/4"	47.80
03005	1"	70.30
03006	1.1/4"	134.70

### Ferrules



R2A Ferrules

0014		£
19940	1/4"	2.60
19941	3/8"	3.40
19942	1/2"	4.30
19943	5/8"	6.65
19944	3/4"	7.60
19945	1"	12.65



R2AT Non-skive Ferrule

0014		£
19950	1/4"	2.40
19951	3/8"	3.20
19956	1/2"	4.30
19953	5/8"	6.30
19954	3/4"	8.25
19955	1"	13.35

Hydraulics

Hydraulic QRC

Pneumatic QRC

Ind. Air Prep., Monitor & Test

KELM™ Pneumatics

Pneumatic & Vacuum Equipment

Valves

Ring Main Systems

Adaptors & Fittings

Stainless Steel

Malleable Iron

Hose, Tubing & Couplings

Clamps & Clips

Sprays & Adhesives

Blow Guns & Vacuum

Wash Down & Fuelling

Air Tools

Tools, Hardware & PPE

SAE O-Ring Face  
Plug c/w O-Ring



0014		£
96000	9/16"	4.85
96001	11/16"	6.30
96002	13/16"	7.10
96003	1"	8.65
96004	1.3/16"	10.45
96005	1.7/16"	13.00

BSPP Female Cross



0014		£
13023	1/8"	48.45
13020	1/4"	25.95
13021	3/8"	34.90
13022	1/2"	42.10
13024	3/4"	51.05
13025	1"	85.20
13026	1.1/4"	152.10

BSPP Swivel  
Female Cross 60° Cone



0014		£
Z4MB02	1/8"	32.10
Z4MB04	1/4"	32.10
Z4MB06	3/8"	34.80
Z4MB08	1/2"	42.10
Z4MB10	5/8"	48.25
Z4MB12	3/4"	50.90
Z4MB16	1"	77.05
Z4MB20	1.1/4"	152.10
Z4MB24	1.1/2"	246.25

NPT Female Cross



0014		£
37000	1/4"	41.70
37001	3/8"	47.50
37002	1/2"	60.60
37004	1"	77.05
37006	1.1/2"	226.60

### Locknuts



BSPP Locknut

0014		£
BLN02	1/8"	1.35
BLN04	1/4"	1.45
BLN06	3/8"	1.55
BLN08	1/2"	1.90
BLN10	5/8"	2.35
BLN12	3/4"	2.30
BLN16	1"	3.70
BLN20	1.1/4"	8.80
BLN24	1.1/2"	10.15
BLN32	2"	20.30

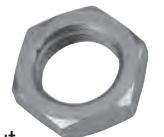

Metric 1.5 Pitch Locknut

0014		£
MLN12	12	2.10
MLN14	14	2.35
MLN16	16	2.40
MLN18	18	2.50
MLN20	20	2.70
MLN22	22	3.40
MLN24	24	4.15