



Hydraulic Tooling

EAGLE PRO

Section 1 – Hydraulics

High Pressure Gauges

Features

- Calibrated with dual scale reading for MPa and PSI, Accuracy, +/-1%.
- Fast, easy to install
- Made of corrosion resistant stainless steel.
- Not affected by motion

Tech Sheet 10083



Gauge Diameter 2.5"

0346			£
EG-2510	1/4" NPT	700	104.25

Gauge Diameter 4"

0346			£
EG-4010	1/2" NPT	700	172.80
EG-4016	M20 x 1.5	1600	289.85
EG-4025	M20 x 1.5	2500	335.80

Gauge Adaptor

- To adapt above gauges to hydraulic system.

Tech Sheet 10084

EGA-001/EGA-002

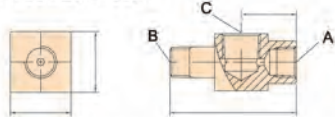

EGA-003/EGA-004/EGA-011

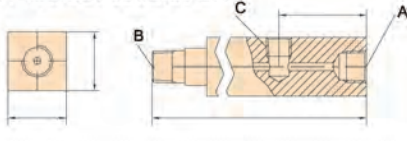

EGA-005

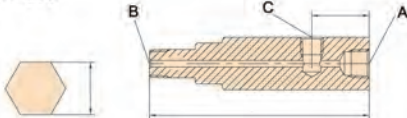

NPT Male/Female

0346				Length mm	£
EGA-001	3/8"	3/8"	1/2"	71	17.70
EGA-002	3/8"	3/8"	1/2"	155	25.35
EGA-003	3/8"	3/8"	1/4"	133	35.65
EGA-004	3/8"	1/4"	1/2"	111	30.50
EGA-005	3/8"	3/8"	1/4"	134	35.65
EGA-011	1/4"	3/8"	1/4"	133	38.45

Hydraulic Valves

Needle Valve

Manually control the speed of cylinder, can be used as shut-off valve for temporary load holding.

Tech Sheet 10085

Manually Operated Check Valve

Used to hold load with single or double acting cylinder, manually opened to allow oil to flow back to oil reserve when cylinder retract



Needle Valve, NPT Female

0346			£
EV-11	3/8"	700	111.85

Check Valve, NPT Female

0346			£
EV-23	3/8"	700	414.45

Hydraulic Nut Splitters

Features

- Compact design for use in confined spaces.
- Unique angled head design.
- Single-acting, spring return cylinder.
- Nut Splitter Blade can be replaced.

Tech Sheet 10086



Single Acting

0346	Capacity Tn	Bolt Range	Hex. Nut Range	£
ENS-001	5	7.87-12.7	9.91-19.05	452.60
ENS-002	10	12.7-16.00	19.05-23.88	597.60
ENS-003	15	16.00-22.35	23.88-28.70	788.35
ENS-004	20	22.35-28.70	28.70-39.62	1080.90
ENS-005	35	28.70-35.05	35.05-50.80	1528.50
ENS-006	50	35.05-38.10	50.80-57.15	1943.00
ENS-007	90	38.10-47.75	60.45-73.15	4059.00