

Body Size

1/2"

Multi-Couplings

# MACH-Series



### Technical Performance Data

| Body Size<br>inch | Temperatur Range   | Maximum operating<br>pressure |
|-------------------|--------------------|-------------------------------|
| 1/2"              | -30°C up to +110°C | 250 bar                       |

### Top Connector (Coupling Plate)

This top connector unit includes the top casting and automatic protective cover, 4 to 7 female quick couplings and a complete locking system. In the most common version with 7 lines, the top connector is also equipped with a 6 line male electrical connector as a standard feature.

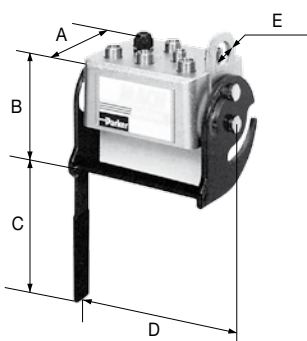

|   | 1/2"    |
|---|---------|
| A | 120 mm  |
| B | 145 mm  |
| C | 160 mm  |
| D | 210 mm  |
| E | ∅ 30 mm |

### Base Connector (Plug Plate)

This base connector unit includes the base casting and automatic protective cover, 4 to 7 male quick couplings and the positioning pins. Also included are an adaptor and a plastic hose to drain oil. In the most common version with 7 lines, the base connector is also equipped with a 6 line male electrical connector as a standard feature.

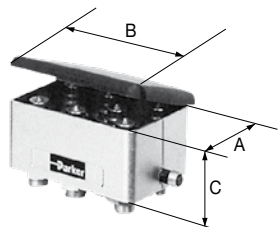

|   | 1/2"   |
|---|--------|
| A | 109 mm |
| B | 170 mm |
| C | 70 mm  |

### Technical Description

The couplings meet the requirements of ISO 7241-1 Series A. Possible to connect 4, 5, 6 or 7 hydraulic lines simultaneously. No coupling misconnection or accidental disconnection. Using a standard interface will still allow end users to connect their standard quick coupling equipped implements. In the version with seven lines (MACH 7), the base connector is equipped with an electrical connector as standard feature, which is an option on the MACH 4, 5 and 6.

### Advantages

Individual ball locking system and central cam locking mechanism: a simple movement enables to connect all the hydraulic lines. Three part poppet style valving with a molded shaped seal to prevent seal washout at high flow rates. Possible to connect with two lines under 200 bar, if other lines are not under pressure. Easy and fast connection and disconnection of implements or tooling.

### Applications

- Agricultural (front loaders, hedge cutters,...)
- Road service vehicles (road systems lorries, road sweepers, snowploughs,...)
- Industrial Applications

### Working Pressure

max. 250 bar

### Working Temperature

-30°C up to +110°C (NBR) depending on the medium.

### Flow Capacity with Oil with Viscosity of 43cSt at 38°C as per ISO 7241/2-2000

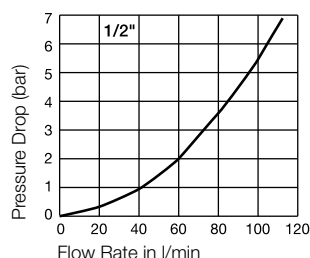

### Material

|                       |               |
|-----------------------|---------------|
| Coupling-/Plug Plates | Steel         |
| Support Plate         | Steel         |
| Protective Cap        | Thermoplastic |
| Couplings and Plugs   | Steel         |
| Seals                 | NBR           |
| Locking Mechanism     | Steel         |
| Connector Castings    | Aluminium     |

### Installation

Base unit: Mounted with 4 screws M 8 x 1,25 mm

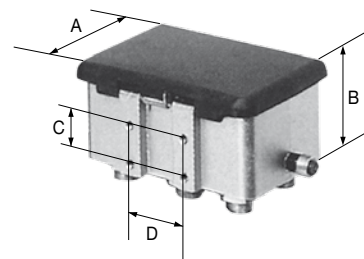

|   | 1/2"   |
|---|--------|
| A | 125 mm |
| B | 80 mm  |
| C | 30 mm  |
| D | 50 mm  |

## Coupling Plate

## MACH-Series

|   | Body Size | Number of Hydraulic Lines | Number of Threads DIN2353 15L (M22x1,5) | Number of Threads DIN2353 12L (M18x1,5) | Electrical Connector | Part Number  |
|---|-----------|---------------------------|---|---|----------------------|--------------|
|  | 1/2"      | 4                         | 4                                       | 0                                       | without              | MACH4/715LT  |
|   | 1/2"      | 4                         | 4                                       | 0                                       | with                 | MACH4/715LTE |
|   | 1/2"      | 5                         | 5                                       | 0                                       | without              | MACH5/715LT  |
|   | 1/2"      | 5                         | 5                                       | 0                                       | with                 | MACH5/715LTE |
|   | 1/2"      | 6                         | 6                                       | 0                                       | without              | MACH6/715LT  |
|   | 1/2"      | 6                         | 6                                       | 0                                       | with                 | MACH6/715LTE |
|   | 1/2"      | 7                         | 6                                       | 1                                       | with                 | MACH7T       |

## Plug Plate

## MACH-Series

|  | Body Size | Number of Hydraulic Lines | Number of Threads DIN2353 15L (M22x1,5) | Number of Threads DIN2353 12L (M18x1,5) | Electrical Connector | Part Number  |
|--|-----------|---------------------------|---|---|----------------------|--------------|
|  | 1/2"      | 4                         | 4                                       | 0                                       | without              | MACH4/715LB  |
|  | 1/2"      | 4                         | 4                                       | 0                                       | with                 | MACH4/715LBE |
|  | 1/2"      | 5                         | 5                                       | 0                                       | without              | MACH5/715LB  |
|  | 1/2"      | 5                         | 5                                       | 0                                       | with                 | MACH5/715LBE |
|  | 1/2"      | 6                         | 6                                       | 0                                       | without              | MACH6/715LB  |
|  | 1/2"      | 6                         | 6                                       | 0                                       | with                 | MACH6/715LBE |
|  | 1/2"      | 7                         | 6                                       | 1                                       | with                 | MACH7B       |

## Oil Drain Kit

|   | Description   | Part Number |
|---|---|-------------|
|  | This kit includes the removable tank to contain oil spillage and a holding fixture. | MACH A      |
|   |   |             |
|   |   |             |
|   |   |             |

**Spare Parts** **MACH-Series**

|   | Description          | End Configuration | Part Number   |
|---|----------------------|-------------------|---------------|
| <p>MACH 8900226</p> <p>MACH 7980035</p> <p>MACH 8900227</p> <p>MACH 8900214</p> <p>MACH 8900213</p> <p>MACH 5400303</p> <p>MACHF08767030</p> <p>JT020117N0552</p> <p>Coupling</p> <p>Plug</p> | Electrical socket    |                   | MACH 8900214  |
|   | Washer               |                   | MACH 8900227  |
|   | Grommet              |                   | MACH 8900226  |
|   | Electrical plug      |                   | MACH 8900213  |
|   | Snap ring            |                   | MACH7980035   |
|   | Counter plate        |                   | MACHF08767030 |
|   | Cover                |                   | MACH5400303   |
|   | Adaptor outside seal |                   | JT020117N0552 |
|   | Coupling             | DIN 2353-15L      | 3V54D6X5MCH   |
|   | Plug                 | DIN 2353-15L      | 4V14E6X5MCHA  |
| Coupling  | DIN 2353-12L         | 3V54D6X4MCH       |               |
| Plug  | DIN 2353-12L         | 4V14E6X4MCHA      |               |
|   |                      |                   |               |
|   |                      |                   |               |
|   |                      |                   |               |
|   |                      |                   |               |