

4020 2/2 In-Line Ball Valve

Inch

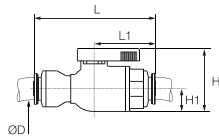

Polypropylene, glass fibre-reinforced, EPDM



ØD		H	H1	L	L1	kg
1/4	4020 56 00WP2	25	13	65	31	0.015
3/8	4020 60 00WP2	36	13	68	30.5	0.028

4021 2/2 In-Line Ball Valve, Male NPTF Thread

Inch



Polypropylene, glass fibre-reinforced, EPDM

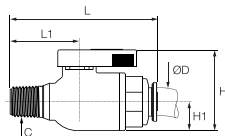

ØD	C		H	H1	L	L1	kg
1/4	NPT1/4	4021 56 14WP2	36	13	61	31	0.029
3/8	NPT3/8	4021 60 18WP2	36	13	64	33.5	0.028

4023 2/2 In-Line Ball Valve, Female NPTF Thread

Inch



Polypropylene, glass fibre-reinforced, EPDM

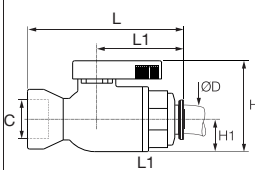

ØD	C		H	H1	L	L1	kg
1/4	NPT1/4	4023 56 14WP2	36	13	58	31	0.000
3/8	NPT3/8	4023 60 18WP2	36	13	64	33.5	0.000

4022 2/2 Right-Angled Ball Valve, Female NPTF Thread

Inch



Polypropylene, glass fibre-reinforced, EPDM

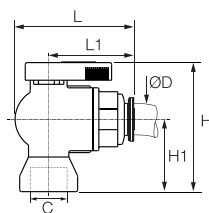

ØD	C		H	H1	L	L1	kg
1/4	NPT1/4	4022 56 14WP2	52	29	44	31	0.016
3/8	NPT3/8	4022 60 18WP2	52	29	47	33.5	0.027

3130 Tamper-Proof Safety Clip

Technical polymer

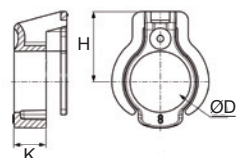

ØD							H	K	kg
1/4	3130 56 01	3130 56 02	3130 56 03	3130 56 04	3130 56 05	3130 56 10	8	3.2	0.001
3/8	3130 60 01	3130 60 02	3130 60 03	3130 60 04	3130 60 05	3130 60 10	10.8	4.2	0.001