

European Profile

25, 26 and 27 Series

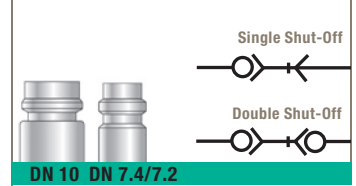

9087 Probe, Straight-Through, Male BSPP Thread



Nickel-plated steel, technical polymer

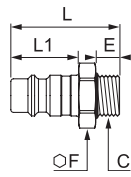

DN	C		E	F	L	L1	kg
7.4	G1/8	9087 25 10	7	13	31	20	0.018
	G1/4	9087 25 13	9	14	34	20	0.018
	G3/8	9087 25 17	9	17	34	20	0.025
10	G1/2	9087 25 21	12	22	38	20	0.047
	G3/8	9087 27 17	9	19	37	22	0.031
	G1/2	9087 27 21	12	22	40	22	0.046
	G3/4	9087 27 27	16	32	45	22	0.085

Probe without shut-off
25 Series probe (DN 7.4) compatible with 26 Series coupler (DN 7.2)

9086 Probe, Straight-Through, Female BSPP Thread



Nickel-plated steel

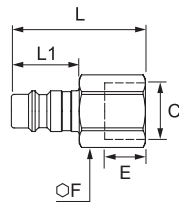

DN	C		E	F	L	L1	kg
7.4	G1/8	9086 25 10	7	14	32	20	0.015
	G1/4	9086 25 13	9	17	38.5	20	0.027
	G3/8	9086 25 17	9	19	33	20	0.027
10	G1/2	9086 25 21	12	24	36	20	0.050
	G3/8	9086 27 17	9	19	34	22	0.026
	G1/2	9086 27 21	12	24	38	22	0.041
	G3/4	9086 27 27	16	32	42	22	0.090

Probe without shut-off
25 Series probe (DN 7.4) compatible with 26 Series coupler (DN 7.2)

9085 Probe, Straight-Through, with Barb Connection



Nickel-plated steel

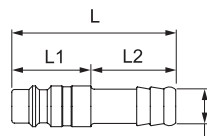

DN	ØD		L	L1	L2	kg
7.4	6	9085 25 06	48	20	25	0.013
	8	9085 25 08	48	20	25	0.015
	9	9085 25 09	48	20	25	0.015
	10	9085 25 10	48	20	25	0.016
	13	9085 25 13	48	20	25	0.020
10	8	9085 27 08	48	22	25	0.021
	10	9085 27 10	48	22	25	0.023
	13	9085 27 13	48	22	25	0.026
	19	9085 27 19	48	22	25	0.038

Probe without shut-off
25 Series probe (DN 7.4) compatible with 26 Series coupler (DN 7.2)

9287 Probe, Valved, Male BSPP Thread



Nickel-plated brass, NBR

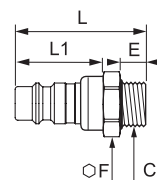

DN	C		E	F	L	L1	kg
7.4	G1/8	9287 25 10	7	22	41	20	0.046
	G1/4	9287 25 13	9	22	43	20	0.046
	G3/8	9287 25 17	9	22	43	20	0.049
10	G1/2	9287 25 21	12	22	46	20	0.060
	G3/8	9287 27 17	9	24	58	22	0.086
	G1/2	9287 27 21	12	24	58	22	0.090
	G3/4	9287 27 27	16	27	62	22	0.132

Probe with shut-off
25 Series probe (DN 7.4) not compatible with 26 Series coupler (DN 7.2)