

Piston rod mountings

Swivel rod eye AP6

Intended for articulated mounting of the cylinder.



Material:
Swivel rod eye, nut: galvanized steel.
Swivel bearing according to DIN 648K: Hardened steel.

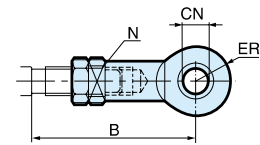

Stainless steel swivel rod eye AP6

Stainless-steel swivel rod eye for articulated mounting of eye cylinder.



Materials
Swivel rod eye: Stainless steel
Swivel bearing according to DIN 648K: Stainless steel
Use stainless steel nut with stainless steel swivel rod eye.

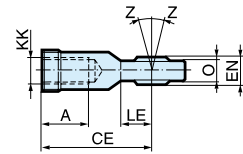

ISO 8139

| Cyl.- dia. mm | A mm | B min mm | B max mm | CE mm | CN H9 mm | EN h12 mm | ER mm | KK | LE | N* min mm | O mm | Z mm | Weight kg | Order code | Order code |
|---------------------|---------|----------------|----------------|----------|----------------|-----------------|----------|----------|----|-----------------|---------|---------|--------------|---------------------|--------------------|
| | | | | | | | | | | | | | | Galvanised Steel | Stainless Steel |
| 32 | 20 | 48,0 | 55 | 43 | 10 | 14 | 14 | M10x1,25 | 15 | 17 | 10,5 | 12° | 0,08 | P1C-4KRS | P1S-4JRT |
| 40 | 22 | 56,0 | 62 | 50 | 12 | 16 | 16 | M12x1,25 | 17 | 19 | 12,0 | 12° | 0,12 | P1C-4LRS | P1S-4LRT |
| 50 | 28 | 72,0 | 80 | 64 | 16 | 21 | 21 | M16x1,5 | 22 | 22 | 15,0 | 15° | 0,25 | P1C-4MRS | P1S-4MRT |
| 63 | 28 | 72,0 | 80 | 64 | 16 | 21 | 21 | M16x1,5 | 22 | 22 | 15,0 | 15° | 0,25 | P1C-4MRS | P1S-4MRT |
| 80 | 33 | 87,0 | 97 | 77 | 20 | 25 | 25 | M20x1,5 | 26 | 32 | 18,0 | 15° | 0,46 | P1C-4PRS | P1S-4PRT |
| 100 | 33 | 87,0 | 97 | 77 | 20 | 25 | 25 | M20x1,5 | 26 | 32 | 18,0 | 15° | 0,46 | P1C-4PRS | P1S-4PRT |
| 125 | 51 | 123,5 | 137 | 110 | 30 | 37 | 35 | M27x2 | 36 | 41 | 25,0 | 15° | 1,28 | P1C-4RRS | P1S-4RRT |

*key grip

Clevis AP2

Intended for articulated mounting of the cylinder.



Material:
Clevis and clip galvanized steel.
Pin: Hardened steel

Supplied complete with axle.

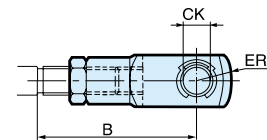

Stainless steel Clevis AP2

Stainless-steel clevis for articulated mounting of cylinder.



Material
Clevis: Stainless steel
Pin: Stainless steel
Circlips according to DIN 471: Stainless steel
Use stainless steel nut with stainless steel swivel rod eye.

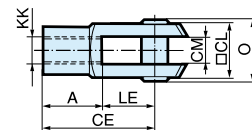

ISO 8140

| Cyl.- dia. mm | A mm | B min mm | B max mm | CE mm | CK mm | CL h11/E9 mm | CM mm | ER mm | KK | LE mm | O mm | Weight kg | Order code | Order code |
|---------------------|---------|----------------|----------------|----------|----------|--------------------|----------|----------|----------|----------|---------|--------------|---------------------|--------------------|
| | | | | | | | | | | | | | Galvanised Steel | Stainless Steel |
| 32 | 20 | 45,0 | 52 | 40 | 10 | 20 | 10 | 16 | M10x1,25 | 20 | 28,0 | 0,09 | P1C-4KRC | P1S-4JRD |
| 40 | 24 | 54,0 | 60 | 48 | 12 | 24 | 12 | 19 | M12x1,25 | 24 | 32,0 | 0,15 | P1C-4LRC | P1S-4LRD |
| 50 | 32 | 72,0 | 80 | 64 | 16 | 32 | 16 | 25 | M16x1,5 | 32 | 41,5 | 0,35 | P1C-4MRC | P1S-4MRD |
| 63 | 32 | 72,0 | 80 | 64 | 16 | 32 | 16 | 25 | M16x1,5 | 32 | 41,5 | 0,35 | P1C-4MRC | P1S-4MRD |
| 80 | 40 | 90,0 | 100 | 80 | 20 | 40 | 20 | 32 | M20x1,5 | 40 | 50,0 | 0,75 | P1C-4PRC | P1S-4PRD |
| 100 | 40 | 90,0 | 100 | 80 | 20 | 40 | 20 | 32 | M20x1,5 | 40 | 50,0 | 0,75 | P1C-4PRC | P1S-4PRD |
| 125 | 56 | 123,5 | 137 | 110 | 30 | 55 | 30 | 45 | M27x2,0 | 54,0 | 72,0 | 2,10 | P1C-4RRC | P1S-4RRD |