

**Cylinder mountings**

**Pivot bracket with swivel bearing AB5**



Intended for use together with clevis bracket GA.

Material:  
 Pivot bracket: Surface-treated steel  
 Swivel bearing acc. to DIN 648K: Hardened steel

According to VDMA 24 562, AFNOR

Cyl. bore mm	CN H7 mm	S5 H13 mm	K1 JS14 mm	K2 mm	EU mm	G1 JS14 mm	G2 JS14 mm	EN mm	G3 mm	CH JS15 mm	H6 mm	ER mm	Z °
32	10	6,6	38	51	10,5	21	18	14	31	32	10	16	4°
40	12	6,6	41	54	12,0	24	22	16	35	36	10	18	4°
50	16	9,0	50	65	15,0	33	30	21	45	45	12	21	4°
63	16	9,0	52	67	15,0	37	35	21	50	50	12	23	4°
80	20	11,0	66	86	18,0	47	40	25	60	63	14	28	4°
100	20	11,0	76	96	18,0	55	50	25	70	71	15	30	4°
125	30	14,0	94	124	25,0	70	60	37	90	90	20	40	4°

Cyl. bore Ø mm	Weight kg	Order code
32	0,18	<b>KC5130</b>
40	0,25	<b>KC5131</b>
50	0,47	<b>KC5132</b>
63	0,57	<b>KC5133</b>
80	1,05	<b>KC5134</b>
100	1,42	<b>KC5135</b>
125	3,10	<b>KC5136</b>

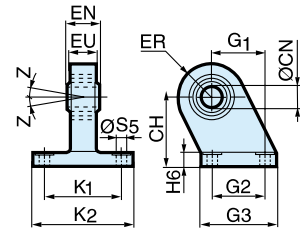

**3 and 4 positions flange**



Mounting kit for back to back mounted cylinders, 3 and 4 position cylinders.

Material:  
 Mounting: Aluminium  
 Mounting screws: Zinc-plated steel 8.8

Cyl. bore mm	E mm	TG mm	ØFB mm	MF mm	A mm	ØBA mm
32	50	32,5	6,5	5	16	30
40	60	38,0	6,5	5	16	35
50	66	46,5	8,5	6	20	40
63	80	56,5	8,5	6	20	45
80	100	72,0	10,5	8	25	45
100	118	89,0	10,5	8	25	55

Cyl. bore Ø mm	Weight kg	Order code
32	0,09	<b>P1E-6KB0</b>
40	0,13	<b>P1E-6LB0</b>
50	0,17	<b>P1E-6MB0</b>
63	0,36	<b>P1E-6NB0</b>
80	0,46	<b>P1E-6PB0</b>
100	0,83	<b>P1E-6QB0</b>

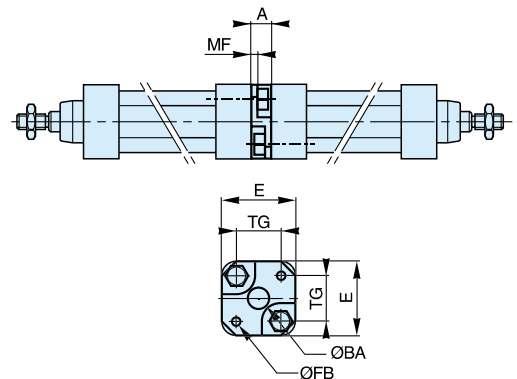

**Pivot brackets AT4 for MT4**



Intended for use together with centre trunnion MT4.

Material:  
 Pivot bracket: Aluminium  
 Bearing: Composite

Supplied in pairs.

Cyl. bore mm	B1 mm	B2 mm	A mm	C mm	d1 mm	d2 H13 mm	H1 mm	H2 mm	fx45° min
32	55	20	36	10,5	12	8,4	26	13	1,0
40	55	20	36	12,0	16	8,4	26	13	1,6
50	55	20	36	12,0	16	8,4	26	13	1,6
63	65	25	42	13,0	20	10,5	30	15	1,6
80	65	25	42	13,0	20	10,5	30	15	1,6
100	75	28	50	16,0	25	13,0	40	20	2,0
125	75	28	50	16,0	25	13,0	40	20	2,0

Cyl. bore Ø mm	Weight kg	Order code
32	0,06	<b>PD23381</b>
40	0,06	<b>PD23382</b>
50	0,06	<b>PD23382</b>
63	0,10	<b>PD23383</b>
80	0,10	<b>PD23383</b>
100	0,175	<b>PD23384</b>
125	0,175	<b>PD23384</b>

