

**Piston rod mountings**

**Flexo coupling PM5**



Flexo coupling for articulated mounting of piston rod. Flexo fitting is intended to take up axial angle errors within a range of  $\pm 4^\circ$ .

Material  
Flexo coupling, nut: Zinc-plated steel

Supplied complete with galvanized adjustment nut.

Cyl. bore Ø mm	Weight kg	Order code
32	0,23	<b>P1C-4KRF</b>
40	0,23	<b>P1C-4LRF</b>
50	0,65	<b>P1C-4MRF</b>
63	0,65	<b>P1C-4MRF</b>
80	0,71	<b>P1C-4PRF</b>
100	0,71	<b>P1C-4PRF</b>
125	1,60	<b>P1C-4RRF</b>

Cyl. bore mm	KK mm	B mm	C mm	D mm	E mm	ØF mm	SW1 mm	SW2 mm	SW3 mm	SW4 mm	SW5 mm
32	M10x1.25	20	23	73	31	21	12	30	30	19	17
40	M12x1.25	24	23	77	31	21	12	30	30	19	19
50	M16x1.5	32	32	108	45	33.5	19	41	41	30	24
63	M16x1.5	32	32	108	45	33.5	19	41	41	30	24
80	M20x1.5	40	42	122	56	33.5	19	41	41	30	30
100	M20x1.5	40	42	122	56	33.5	19	41	41	30	30
125	M27x2	54	48	147	51	39	24	55	55	32	41

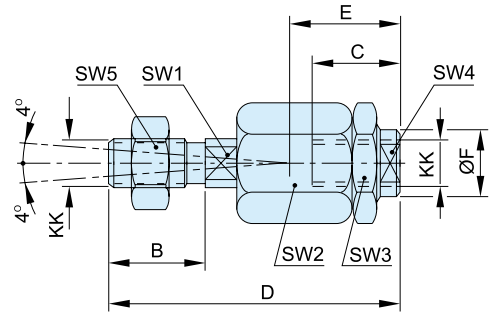

**Nut MR9 \***



Intended for fixed mounting of accessories to the piston rod.  
Material: Zinc-plated steel  
Supplied as pack of 10 off

All P1D cylinders are delivered with a zinc-plated steel piston rod nut.

Cyl. bore Ø mm	Weight** kg	Order code
32	0,007	<b>P14-4KRPZ</b>
40	0,010	<b>P14-4LRPZ</b>
50	0,021	<b>P14-4MRPZ</b>
63	0,021	<b>P14-4MRPZ</b>
80	0,040	<b>P14-4PRPZ</b>
100	0,040	<b>P14-4PRPZ</b>
125	0,100	<b>P14-4RRPZ</b>

According to DIN 439 B

Cyl. bore mm	A mm	B mm	C
32	17	5,0	M10x1,25
40	19	6,0	M12x1,25
50	24	8,0	M16x1,5
63	24	8,0	M16x1,5
80	30	10,0	M20x1,5
100	30	10,0	M20x1,5
125	41	13,5	M27x2

\* Supplied as pack of 10 off  
\*\* Weight per item

